

EFZ EV Fuse

RoHS



DESCRIPTION

The Adler EFZ 1500 Vdc automotive fuse series is specially engineered and tested to provide best-in-class protection performance in protecting high power battery charging and managing systems of Electrical Vehicles and Hybrid Electrical Vehicles, up to 1500 Vdc in ratings from 100 A to 300 A.

FEATURES

- 1500 Vdc automotive and charging fuse
- Rated currents from 160 A – 300 A
- Braking Capacity of 30 kA
- Fast acting fuse for EV/HEV applications

APPLICATIONS

- BDU Protection
- Drive Train Protection
- EV/HEV Power Management and Protection

AGENCY INFORMATION

- Manufactured in accordance with UL 248-20, JASO D6822
- Approvals: UL (pending).

PART NUMBER SYSTEM

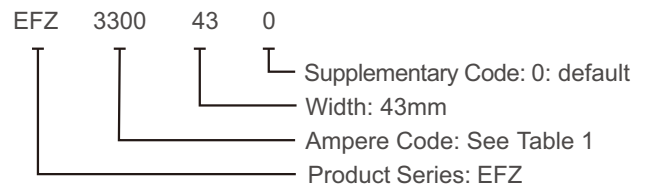

ELECTRICAL SPECIFICATIONS

Size (mm)	Part Number	Rated Current	Ampere Code	Rated Voltage	Breaking Capacity Self-test	I ² t (A ² sec)		1.0 In Dissipation (W)
						Pre-arcing	Total @ 1500Vdc	
84x43	EFZ3100430	100A	3100	1500 Vdc	30 kA	1680	10700	32
	EFZ3160430	160 A	3160			4500	29000	45
	EFZ3200430	200 A	3200			75300	51000	53
	EFZ3250430	250 A	3250			12400	86800	62
	EFZ3300430	300 A	3300			18810	137500	72

Table1 Note: 1. Temperature rise: 0.5In<50 K.
2. Recommended mounting torque is 12+/-1.0Nm (M8)

DIMENSIONS (mm):

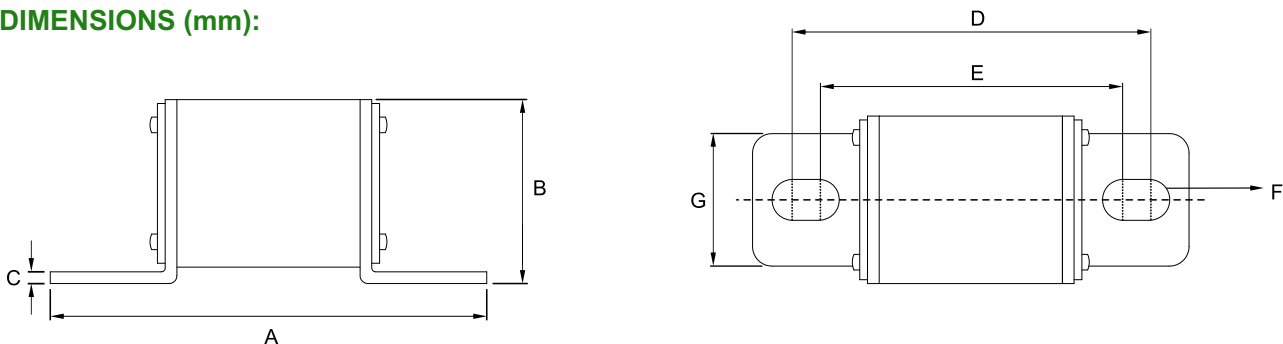

Part Number	A	B	C	D	E	F	G
EFZxxx430	136	47.2	3	116	103	φ10.3	26

Table2

TIME CURRENT CURVE

