

EFX EV Fuse

RoHS



DESCRIPTION

Adler EFX series EV fuses are specially engineered and tested to provide best-in-class protection performance in protecting high power battery charging and managing systems of Electrical Vehicles and Hybrid Electrical Vehicles, up to 1000 Vdc in ratings from 550A to 800A.

FEATURES

- Reliable clearing of DC fault currents
- High cycling performance
- Low watt losses
- Ultra-compact size and power density
- High breaking capacity to 50kA
- Strong ability to withstand high current pulse
- Full coverage of battery module current
- QR code marks on each fuse for traceability

APPLICATIONS

- BDU Protection
- Drive Train Protection
- EV/HEV Power Management and Protection

AGENCY INFORMATION

- Designed to UL248-20, VW80000
- Manufactured under IATF 16949 quality system
- RoHS and REACH Compliant

PART NUMBER SYSTEM

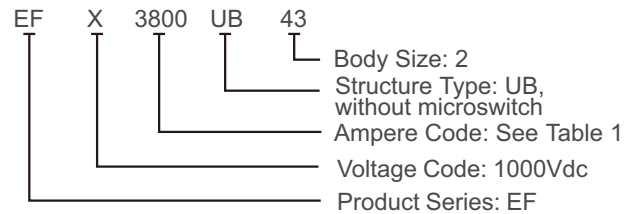

ELECTRICAL SPECIFICATIONS

Size (mm)	Part Number			Rated Current	Ampere Code	Rated Voltage	Breaking Capacity		Pre-arcing I ² t (A ² s)	Clearing I ² t (A ² s)	Watt Loss (W) 0.5In
	Din	Bolted	Flush				TUV	Self-Certified			
59x59 x70	EFX3550DB2	EFX3550UB2	EFX3550FB2	550A	3550	1000Vdc	-	50kA	93500	454000	18
	EFX3630DB2	EFX3630UB2	EFX3630FB2	630A	3630	1000Vdc	-	50kA	133000	652000	20
	EFX3700DB2	EFX3700UB2	EFX3700FB2	700A	3700	1000Vdc	-	50kA	169000	838000	23
	EFX3800DB2	EFX3800UB2	EFX3800FB2	800A	3800	1000Vdc	-	50kA	232000	1159000	25

Table1 Note: Time constant: 2 ± 0.5ms

DIMENSIONS (mm):

EFXxxxxDB2

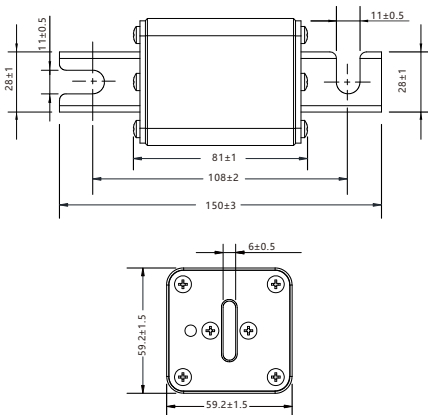

EFXxxxxUB2

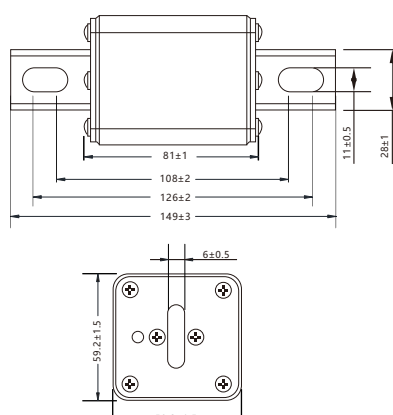

EFXxxxxFB2

