

EFT EV Fuse



DESCRIPTION

Adler EFT series EV fuses are specially engineered and tested to provide best-in-class protection performance in protecting high power battery charging and managing systems of Electrical Vehicles and Hybrid Electrical Vehicles, up to 200 Vdc in ratings from 100A to 500A.

FEATURES

- Main Body: Ceramic
- Reliable clearing of DC fault currents
- Low watt losses
- Ultra-compact size and power density
- High breaking capacity to 20kA
- For Short Circuit Protection

APPLICATIONS

- Portable energy storage
- HEV
- Electric motorcycle
- E-bike
- Industrial Machinery(Forklift/Excavator/Bulldozer)
- Garden tools

AGENCY INFORMATION

- Designed to UL 248-13, ISO 20934-2019
- Manufactured under IATF 16949 quality system
- RoHS and REACH Compliant

PART NUMBER SYSTEM

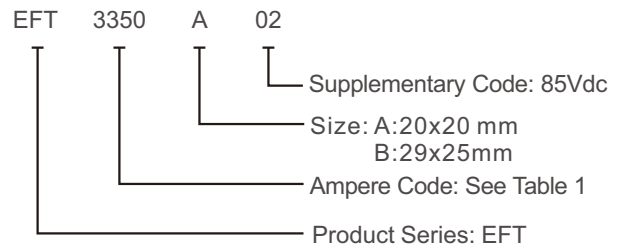

ELECTRICAL SPECIFICATIONS

Part Number	Rated Current	Ampere Code	Rated Voltage	Breaking Capacity	Pre-Arcing I ² t (A ² s)
EFT3100AA0	100 A	3100	150Vdc	3In-20kA	7200
EFT3150AA0	150 A	3150			16000
EFT3200AA0	200 A	3200			28500
EFT3250AA0	250A	3250			65400
EFT3300AA0	300A	3300			89300
EFT3350AA0	350A	3350			122500
EFT3400AA0	400 A	3400	125Vdc	3In-20kA	192000
EFT3500AA0	500 A	3500			276000
EFT3350A02	350 A	3350	85Vdc	3In-20kA	122500
EFT3400A02	400 A	3400			192000
EFT3500A02	500 A	3500			276000
EFT3350A05	350A	3350	63Vdc	3In-20kA	122000
EFT3400A05	400A	3400			191000
EFT3500A05	500A	3500			275500
EFT3350B01	350A	3350	200Vdc	3In-20kA	-
EFT3350B01	400A	3400			-

Table1 Note: 1.Pre-arcing I²t values are typical and tested at 10*In current.
2. * Self certified for Breaking Capacity 20kA

DIMENSIONS (mm)

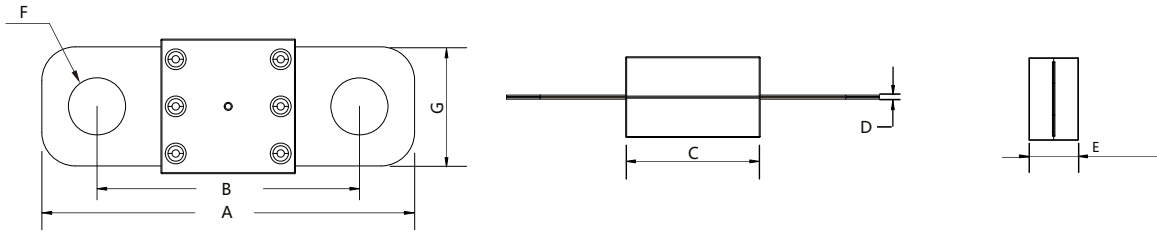

Size	A	B	C	D	E	F	G
20x20	55.4+1/-0.5	39±0.3	20+0.5/-0.1	0.6+0.1/-0.05	12+0.5/-0.2	φ 8.5±0.3	17±0.5
29x25	78±1	56±0.5	29+0.6/-0.2	0.9±0.1	16+0.6/-0.2	φ 8.2±0.2	22.7±0.5

Table1

TIME VS CURRENT CHARACTERISTIC

Part Number	Rated Current	100 %	300 %
EFTxxxxAxx	100-500 A	>4h	<10s

TIME CURRENT CURVE

EFTxxxxAxx 100A-500A

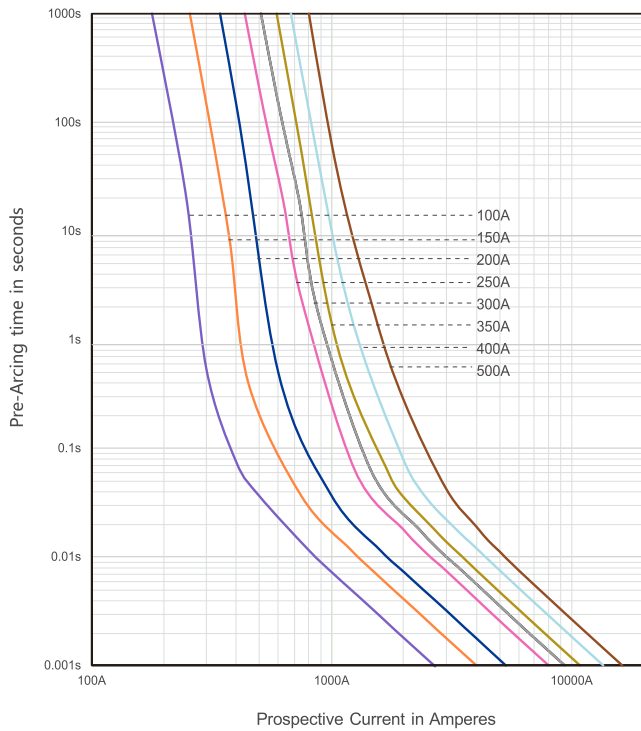

EFTxxxxBxx 350A-400A

