

EF5 EV FUSE



DESCRIPTION

Adler EF5 series EV fuses are specially engineered and tested to provide best-in-class protection performance in protecting high power battery charging and managing systems of Electrical Vehicles and Hybrid Electrical Vehicles, up to 500 Vdc in ratings from 100A to 400A.

FEATURES

- Reliable clearing of DC fault currents
- High cycling performance
- Low watt losses
- Ultra-compact size and power density
- High breaking capacity to 50kA
- Operation as low as 410% In overload protection
- QR code marks on each fuse for traceability

APPLICATIONS

- Battery pack protection
- Traction inverter protection
- Energy storage
- Power conversion
- High voltage power distribution
- Battery disconnect unit

AGENCY INFORMATION

- Designed to UL 248-20
- UL Recognized Component
- Manufactured under IATF 16949 quality system
- RoHS and REACH Compliant

PART NUMBERING SYSTEM

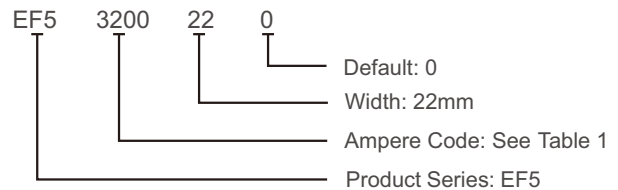

ELECTRICAL SPECIFICATIONS

Size(mm)	Part Number	Rated Current	Ampere Code	Rated Voltage	Breaking Capacity (UL ^{**})	I ² T(A ² sec)		Watt Loss(W)
						Pre-arcing	Total @ 500Vdc	1.0 In
49x22	EF53100220	100 A	3100	500 Vdc	5.1In~50 kA	1770	7020	14.9
	EF53125220	125A	3125			2850	11500	19.3
	EF53150220	150 A	3150			4150	15770	23.1
	EF53175220	175 A	3175			5970	22850	27.5
	EF53200220	200 A	3200			9350	36500	30.8
	EF53250220	250 A	3250			16600	67800	35.2
49x36	EF53300370	300 A	3300	500 Vdc	5.1In~50 kA	20500	67500	7.1
	EF53350370	350 A	3350			32600	107580	7.85
	EF53400370	400 A	3400			42250	148000	9.8

Table1 1. ** --- UL File: E506668
2. Recommend mounting torque is 12+/-1.0Nm (M8)

DIMENSIONS (mm)

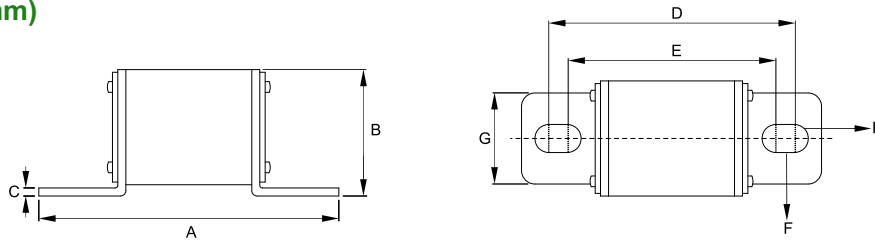

Size	A	B	C	D	E	F	G	H
49x22	90	25	2	74.5	63	8.5	20	Φ 8.5
49x36	92	24	2	75	63	8.5	32.5	Φ 8.5

Table2

TIME CURRENT CURVE

