

BFR Series EV Fuse Holder



FEATURES:

The ADLER BFR series EV fuse holder uses special materials to withstand highest fault currents and temperatures for automotive fuses and applications.

DIMENSIONS (mm)

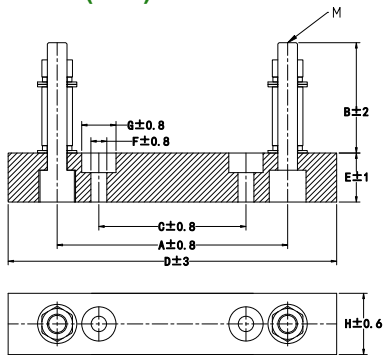

DESCRIPTION:

The BFR series EV fuse holder is suitable for use with automotive equipment and designed for ADLER EV fuse links.

SPECIFICATIONS:

- Rated Voltage: 1000 Vac / dc
- Rated Current: $\leq 200A$
- Operating temperature: $-50^{\circ}C$ to $+180^{\circ}C$
- Max Voltage: 13-18 kV
- Insulation Board Material: FR4
- Insulation Resistance: 50, 000 M Ω
- Metal Material: stainless steel
- UL-94 Flame retardant grade: 94HB

EV HOLDER MATCHING FUSE

P/N	Matching Fuse
BFR063-38-M6-S	AE5xxx620
BFR071-46-M8-S	AE5xxx625, AE5xxx631, AT5xxx604
BFR094-45-M8-S	AE7xxx125
BFR099-70-M10-S	AE7xxx138, AE7xxx151
BFR106-46-M8-S	AEXxxx731
BFR116-72-M10-S	AEXxxx738, AEXxxx751
BFR091-35-M8-S	AT8xxx302
BFR101-45-M10-S	AT7xxxC03, ATXxxxC01
BFR086-45-M8-S	AT8xxx702
BFR082-45-M10-S	AT5xxxB04
BFR065-45-M10-S	AT2xxxE00
BFR043-28-M6-S	AT1xxx105
BFR050-28-M8-S	AEYxxx900, AEYxxx901

P/N	A	B	C	D	E	F	G	H	M
BFR063-38-M6	63	38	31	84	15	5.5	9	25	M6
BFR071-46-M8	71	46	25	96	15	8.5	14	30	M8
BFR094-45-M8	94	45	60	134	20	6.5	14	25	M8
BFR099-70-M10	99	70	60	146	20	6.5	14	42	M10
BFR106-46-M8	106	46	60	146	20	6.5	14	35	M8
BFR116-72-M10	116	72	60	146	20	6.5	14	42	M10
BFR091-35-M8	91.5	35	25	130	15	8.5	17	30	M8
BFR101-45-M10	101.5	45	40	150	25	8.5	17	48	M10
BFR086-45-M8	86.8	45	35	130	20	8.5	17	42	M8
BFR082-45-M10	82.5	45	40	130	25	8.5	17	48	M10
BFR065-45-M10	65	45	30	115	25	8.5	17	48	M10
BFR043-28-M6	43	28	15	70	15	5.5	9	25	M6
BFR050-28-M8	50.9	28	15	80	15	5.5	9	30	M8