

## AEL High Speed Fuse



### DESCRIPTION

Adler AEL series EV fuses are specially engineered and tested to provide best-in-class auxiliary protection and high-performance protection in managing systems of Electrical and Hybrid Electrical Vehicles, up to 80 Vdc in ratings from 30 - 800A. The AEL was specially built from the ground up to meet the stringent requirements and standards of the electric vehicle industry.

### FEATURES

- 80 VDC EV high speed fuse
- Rated Current: 30-800 A
- Rated Breaking Capacity: 3 kA at 80 Vdc
- Bolt Size: M10
- Torque: M10:19 N·m ;
- Recommended fuse holder:  
BHR061-25-M10(with cover):30-200A;  
BHR061-25-M10-S(No cover):30-800A;

### AGENCY INFORMATION

- Designed to UL 248; DIN 43560
- Manufactured under IATF 16949 quality system
- RoHS and REACH Compliant

### APPLICATIONS

- Battery pack protection
- Traction inverter protection
- Energy storage
- Power conversion
- High voltage power distribution
- Battery disconnect unit
- Primary Fuse
- Charging Fuse
- Auxiliary Fuses

### PART NUMBER SYSTEM

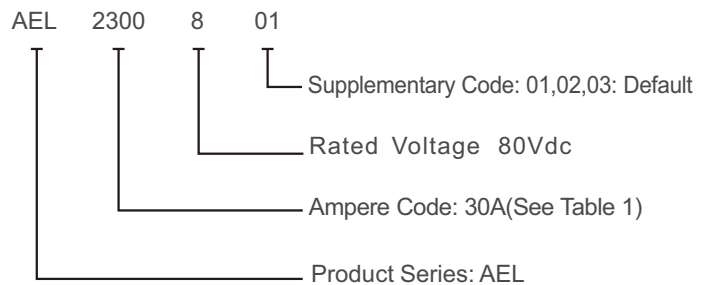

### DIMENSIONS (mm)

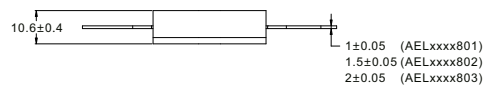
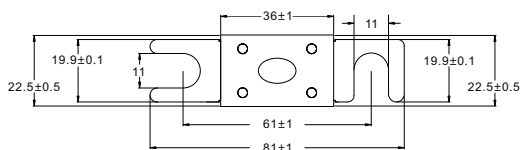

## ELECTRICAL SPECIFICATIONS

| Part Number | Rated Current | Ampere Code | Rated Voltage | Breaking Capacity | Certifications |     |
|-------------|---------------|-------------|---------------|-------------------|----------------|-----|
|             |               |             |               |                   | UL             | TUV |
| AEL2300801  | 30 A          | 2300        | 80 Vdc        | 3kA@80 Vdc        | ●              | ●   |
| AEL2400801  | 40 A          | 2400        |               |                   | ●              | ●   |
| AEL2500801  | 50 A          | 2500        |               |                   | ●              | ●   |
| AEL2600801  | 60 A          | 2600        |               |                   | ●              | ●   |
| AEL2700801  | 70A           | 2700        |               |                   | ●              | ●   |
| AEL2800801  | 80 A          | 2800        |               |                   | ●              | ●   |
| AEL3100801  | 100 A         | 3100        |               |                   | ●              | ●   |
| AEL3125801  | 125 A         | 3125        |               |                   | ●              | ●   |
| AEL3130801  | 130 A         | 3130        |               |                   | ●              | ●   |
| AEL3150801  | 150 A         | 3150        |               |                   | ●              | ●   |
| AEL3175801  | 175 A         | 3175        |               |                   | ●              | ●   |
| AEL3200801  | 200 A         | 3200        |               |                   | ●              | ●   |
| AEL3225801  | 225 A         | 3225        |               |                   | ●              | ●   |
| AEL3250801  | 250 A         | 3250        |               |                   | ●              | ●   |
| AEL3275801  | 275 A         | 3275        |               |                   | ●              | ●   |
| AEL3300801  | 300 A         | 3300        | ●             | ●                 |                |     |
| AEL3325801  | 325 A         | 3325        | ●             | ●                 |                |     |
|             |               |             |               |                   |                |     |
| AEL3350802  | 350 A         | 3350        | 80 Vdc        | 3kA@80 Vdc        | ●              | ●   |
| AEL3400802  | 400 A         | 3400        |               |                   | ●              | ●   |
| AEL3500802  | 500 A         | 3500        |               |                   | ●              | ●   |
| AEL3600802  | 600 A         | 3600        |               |                   | ●              | ●   |
|             |               |             |               |                   |                |     |
| AEL3675803  | 675 A         | 3675        | 80 Vdc        | 3kA@80 Vdc        | ●              | ●   |
| AEL3700803  | 700A          | 3700        |               |                   | ●              | ●   |
| AEL3750803  | 750 A         | 3750        |               |                   | ●              | ●   |
| AEL3800803  | 800 A         | 3800        |               |                   | ●              | ●   |

Table1 Note:1. ●=Certification obtained. UL File number:xxxxxx  
2. Temperature rise: <50 K.

## TIME CURRENT CURVE

AELxxx801

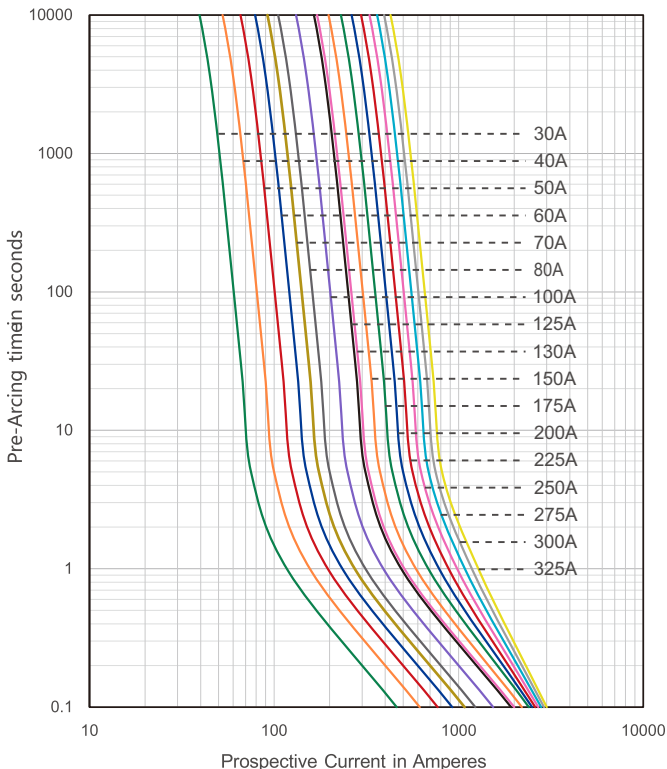

## TIME CURRENT CURVE

AELxxx802/AELxxx803

