

AE6 EV Fuse

RoHS



DESCRIPTION

Adler AE6 EV fuses series are specially engineered and tested to provide best-in-class auxiliary and high-performance protection in managing systems of Electrical and Hybrid Electrical Vehicles. With up to 1000 Vdc in ratings from 5 - 60A. The AE6 was specially built meet the stringent requirements and standards of the electric vehicle industry.

FEATURES

- 1000 Vdc automotive fuse
- Rated Current: 5-15 A (10x38 mm)
20-30 A (14x51 mm)
35-60 A (14x65 mm)
- Max. BC: 20 kA@1000 Vdc
- Min. BC: 2In@1000 Vdc
- Time Constant: 2±0.5ms
- Size: 10x38 mm, 14x51 mm, 14x65 mm

APPLICATIONS

- Battery pack protection
- Traction inverter protection
- Energy storage
- Power conversion
- High voltage power distribution
- Battery disconnect unit
- Primary Fuse

AGENCY INFORMATION

- Designed to ISO 8820-8; GB/T 31465.6;UL 248-20; JASO D622
- Manufactured under IATF 16949 quality system
- RoHS and REACH Compliant

PART NUMBER SYSTEM

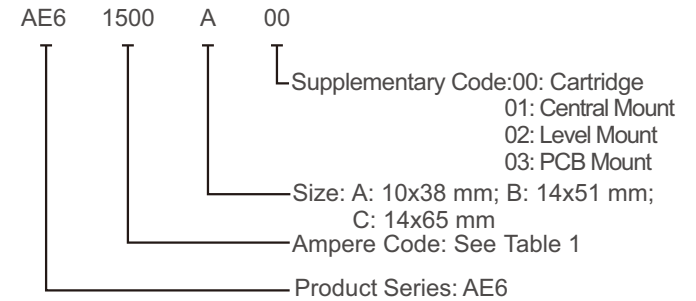

ELECTRICAL SPECIFICATIONS

Size (mm)	Part Number				Rated Current	Ampere Code	Rated Voltage	Breaking Capacity	I ² t(A ² s)		Dissipation(W)	
	Cartridge	Central Mount	Level Mount	PCB Mount					Pre-Arcing	Total	0.7In	1.0In
10x38	AE61500A00	AE61500A01	AE61500A02	AE61500A03	5 A	1500	1000 Vdc	20 kA@1000 Vdc	105	182	1.5	2.2
	AE61600A00	AE61600A01	AE61600A02	AE61600A03					115	196	1.6	2.3
	AE61800A00	AE61800A01	AE61800A02	AE61800A03	8 A	1800			135	220	1.7	2.5
	AE62100A00	AE62100A01	AE62100A02	AE62100A03					160	255	2	3
	AE62120A00	AE62120A01	AE62120A02	AE62120A03	12 A	2120			255	410	1.6	2.4
	AE62150A00	AE62150A01	AE62150A02	AE62150A03					370	620	1.7	2.5
14x51	AE62200B00	-	AE62200B02	AE62200B03	25 A	2250	1000 Vdc	20 kA@1000 Vdc	975	2150	2.2	3.8
	AE62250B00	-	AE62250B02	AE62250B03					1240	3150	2.4	4.4
	AE62300B00	-	AE62300B02	AE62300B03					1.70K	4.45K	2.8	5.2
14x65	AE62350C00	-	AE62350C02	AE62350C03	40 A	2400	1000 Vdc	20 kA@1000 Vdc	2.90K	8.15K	2.5	6.4
	AE62400C00	-	AE62400C02	AE62400C03					5.27K	12.0K	2.7	7.7
	AE62450C00	-	AE62450C02	AE62450C03	50 A	2500			7.45K	13.9K	2.8	7.8
	AE62500C00	-	AE62500C02	AE62500C03					9.30K	16.0K	2.9	7.9
	AE62600C00	-	AE62600C02	AE62600C03					12.5K	19.6K	3	9

Table1 Note: (1) Temperature rise: <50 K.

DIMENSIONS (mm): 10x38

AE6xxxxA00

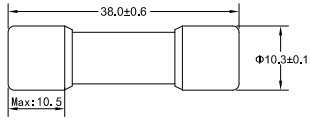

AE6xxxxA01

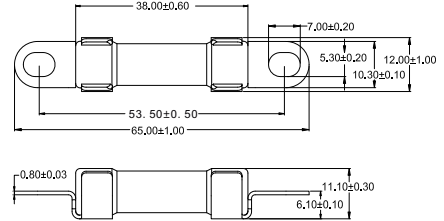

AE6xxxxA02

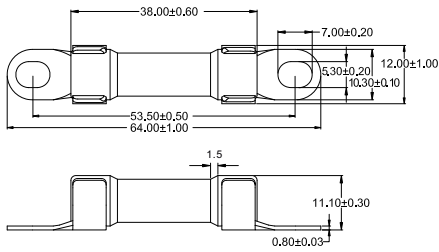

AE6xxxxA03

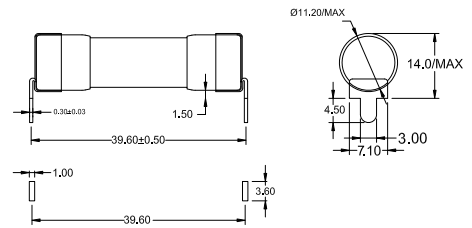

AE6xxxxB00

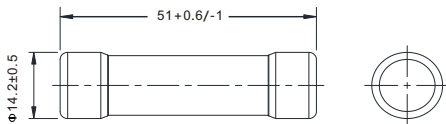

AE6xxxxB02

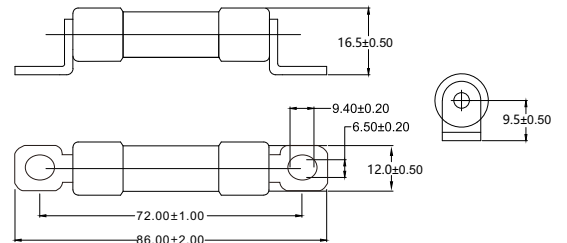

AE6xxxxB03

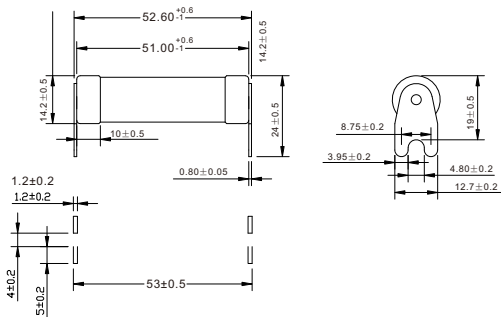

AE6xxxxC00

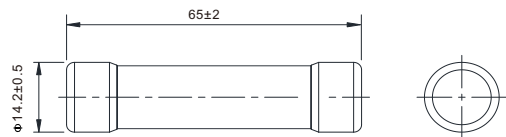

AE6xxxxC02

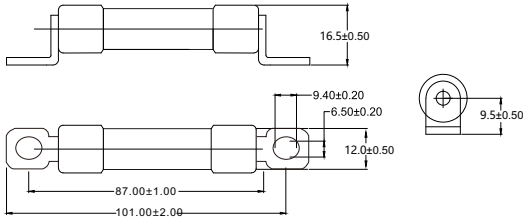

AE6xxxxC03

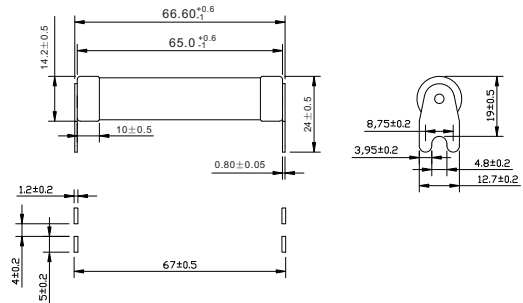

TIME VS CURRENT CHARACTERISTIC

Rated Current	110 %	135 %	150 %	200 %	300 %	500 %
5-60 A	>4 h	<1 h	10-1000 s	0.5-100 s	0.1-15 s	0.05-1 s

TIME CURRENT CURVE

